

Project: _____

Fixture Type: _____ Quantity: _____

Customer: _____



Specifications

Material:
RLM shades are constructed of heavy duty spun aluminum. Wall back plate and ballast housing are cast aluminum. All fasteners are stainless steel. Inside of shade is reflective white finish for all colors except galvanized paint finish. Screw hardware may not match paint.

Glass:
Choice of clear, frosted or prismatic glass.

Ballasts:
HID Ballast shall be high power factor EISA compliant with a lamp starting temperature down to -20°C. Sockets will be medium/mogul base porcelain 4Kv rated.

Fluorescent Ballast will be electronic. Fluorescent sockets will be 4 pin to accept quad or triple tube lamps.

Electrical:
Medium Base Socket; Multi-tap 120v, 208v, 240v & 277v.

Finish:
A polyester powder coat high quality finish is electro-statically applied and baked at 430° for exceptional durability and color retention. Products undergo an intensive five-step cleansing and pretreatment process for maximum paint adhesion.

Marine grade finish provides superior salt, humidity and UV protection. This coating withstands up to 3000 hours of continuous salt spray, comes with a 5-year warranty and is available in either a textured or gloss surface.

Certifications:
Cord mounts are UL Listed for dry locations. Arm mount, stem mount and wall mount are UL Listed for wet locations.

Modifications:
Consult factory for custom or modified luminaires.

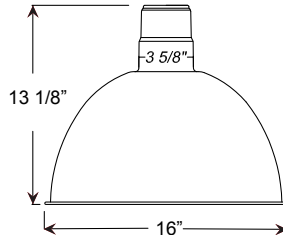

D616
CFL

Weight: 1.5 lbs.

Catalog Logic

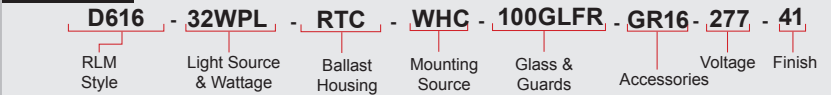

| Catalog Number | | 1 | 2 | 3 | 4 | 5 | 6 | 7 | | |
|----------------|------------------------------------|---|--------------|------------|---|-------------------------|----------|---|--|--|
| | | D616 | 32WPL | RTC | WHC | 100GLFRGUPC | | | | |
| 1 | LIGHT SOURCE & WATTAGES | | | | 3 | MOUNTING SOURCES | 4 | | | |
| | | Flourescent (CFL) | | | Arm Mounts (Cast Back Plate (CB) Included) | | | Up to 100w Options | | |
| | | GU24 Socket Option | | | E3 E4 E5 E6 E8 E9 | | | 100GLCL (Clear Glass) | | |
| | | 26WPL | | | E10 E11 E12 E13 E15 E18 | | | 100GLFR (Frosted Glass) | | |
| | | 32WPL | | | E19 E25 E26 | | | 100GLPR (Prismatic Glass) | | |
| | | 42WPL | | | (See Step 2 for Ballast Housing Options) | | | 100GLCLGUP (Clear Glass & Small Wire Guard) | | |
| | | 26CFLDIM | | | Wall Mounts | | | 100GLFRGUP (Frosted Glass & Small Wire Guard) | | |
| | | 32CFLDIM | | | WM40 | | | 100GLPRGUP (Prismatic Glass & Small Wire Guard) | | |
| | | 42CFLDIM | | | WM54 | | | 100GLCLGUPC (Clear Glass & Cast Guard) | | |
| | | (Compact Fluorescent dimming is 0-10v and ballast must be located within 12" of lamp) | | | WM74 (CFL Only) | | | 100GLFRGUPC (Frosted Glass & Cast Guard) | | |
| 2 | BALLAST HOUSING | | | | Post Mounts (Postline ballast only; 4" OD pole required) | | | 100GLPRGUPC (Prismatic Glass & Cast Guard) | | |
| | | Flourescent (CFL) | | | PM10 | | | 100GLGUP (Small Wire Guard with No Glass) | | |
| | | RTC (CFL Ballast Canopy) | | | PM20 | | | 100GLGUPC (Cast Guard with No Glass) | | |
| | | RTCNC (CFL Ballast Canopy/No Spun Cover) | | | PM30 | | | AC (Stipple Glass Acorn) | | |
| | | DBH (Dimming CFL Ballast Housing) | | | PM40 | | | 100GLBG (White Ball Glass) | | |
| | | | | | PM50 | | | Up to 200w Options | | |
| | | | | | PM84 | | | 200GLCL (Clear Glass) | | |
| | | | | | Cord Mounts | | | 200GLFR (Frosted Glass) | | |
| | | | | | BLC (6' black cord with 1" x 5 3/8" canopy) | | | 200GLPR (Prismatic Glass) | | |
| | | | | | WHC (6' white cord with 1" x 5 3/8" canopy) | | | 200GLCLGUP (Clear Glass & Large Wire Guard) | | |
| | | | | | Stem Mounts | | | 200GLFRGUP (Frosted Glass & Large Wire Guard) | | |
| | | | | | 1/2" (13/16" OD Rigid Stems with STC Flat Canopy) | | | 200GLPRGUP (Prismatic Glass & Large Wire Guard) | | |
| | | | | | 2ST6 2ST12 2ST18 2ST24 2ST36 2ST48 | | | 200GLCLGUPC (Clear Glass & Large Cast Guard) | | |
| | | | | | 2ST60 2ST72 2ST96 | | | 200GLFRGUPC (Frosted Glass & Large Cast Guard) | | |
| | | | | | 3/4" (1" OD Rigid Stems with STC Flat Canopy) | | | 200GLPRGUPC (Prismatic Glass & Large Cast Guard) | | |
| | | | | | 3ST6 3ST12 3ST18 3ST24 3ST36 3ST48 | | | 200GLGUP (Large Wire Guard with No Glass) | | |
| | | | | | 3ST60 3ST72 3ST96 | | | 200GLGUPC (Large Cast Guard with No Glass) | | |
| | | | | | (See Step 2 for Ballast Housing Options) | | | | | |

Project: _____

Fixture Type: _____ Quantity: _____

Customer: _____

| 5 ACCESSORIES | |
|----------------|---|
| EMG-CFL | (CFL Emergency Ballast, remote placement) |
| GR16 | (16" Wire Grill) |

| 6 VOLTAGES | | | |
|------------|------------|------------|------------|
| 120 | 208 | 240 | 277 |

WARRANTY
See www.anplighting.com for complete fixture warranty.

| 7 FINISHES | | | | | |
|----------------|--------------|-----------------------|----------------|--------------|-------------------------------|
| Standard Grade | Marine Grade | | Standard Grade | Marine Grade | |
| 40 | NA | Raw Unfinished | 53 | 100 | Copper Clay |
| 41 | 101 | Black | 56 | 109 | Silver |
| 42 | 102 | Forest Green | 61 | 106 | Black Verde |
| 43 | 114 | Bright Red | 70 | 118 | Painted Chrome |
| 44 | 107 | White | 71 | 105 | Painted Copper |
| 45 | 112 | Bright Blue | 72 | 108 | Textured Black |
| 46 | 123 | Sunny Yellow | 73 | 125 | Matte Black |
| 47 | 120 | Aqua Green | 76 | 121 | Textured Architectural Bronze |
| 49 | NA | Galvanized | 77 | 127 | Textured White |
| 50 | 111 | Navy | 78 | 124 | Textured Silver |
| 51 | 103 | Architectural Bronze | 10 | 130 | Aspen Green |
| 52 | 104 | Patina Verde | 11 | 131 | Cantaloupe |
| 12 | 133 | Lilac | 13 | 132 | Putty |
| Premium Grade | Marine Grade | | Premium Grade | Marine Grade | |
| 81 | 129 | Extreme Chrome | 64 | 116 | Candy Apple Red |
| 80 | 117 | Textured Desert Stone | 65 | 122 | Cobalt Blue |
| 67 | 119 | Butterscotch | 82 | 128 | Graystone |
| 66 | 115 | Caramel | 69 | 113 | Gunmetal Gray |
| 68 | 126 | Black Silver | 83 | 134 | Oil Rubbed Bronze |

Consult factory for additional paint charges and availability

Project: _____

Fixture Type: _____ Quantity: _____

Customer: _____



ARM MOUNTS | Dimensions are Projection x Height | CB included with all arms

| | | | |
|--|--|--|---|
|  E3 32" x 11 7/8" |  E4 26" x 14" |  E5 37" x 16 1/2" |  E6 26" x 9 1/4" |
|  E8 29 1/4" x 12 1/2" |  E9 28" x 40 5/8" |  E10 52 1/4" x 18" |  E11 35 1/4" x 17 1/4" |
|  E12 37 3/8" x 2" |  E13 34" x 34 3/8" |  E15 13 3/8" x 10 1/2" |  E18 27 3/4" x 21 3/8" |
|  E19 22 3/4" x 95 1/8" |  E25 23" x 5 1/4" |  E26 8 1/8" x 6" | |





WALL MOUNTS | Dimensions are Projection x Height | **POST MOUNTS** | Dimensions are Projection x Height

| | | | |
|--|--|---|---|
|  WM40 13 7/8" x 14 3/4" |  WM54 23 3/8" x 14 1/4" |  PM10 14 1/2" x 25" |  PM20 30 1/8" x 25" |
|  WM74 22" x 26 1/2" (CFL Only) |  WM75 25" x 26 1/2" (HID Only) |  PM30 21 5/8" x 28 7/8" |  PM40 43 3/8" x 28 7/8" |
|  WM84 26 1/2" x 57 1/4" |  WM317 15" x 12" (CFL Only) |  PM50 27" x 38" |  PM319 16 5/8" x 27 1/2" |

ACCESSORIES

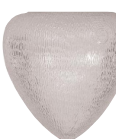
| | |
|---|---|
|  EMG-FL |  GR16 |
|---|---|

GLASS & GUARDS

| | |
|---|---|
| Glass Legend: CL = Clear FR = Frosted PR = Prismatic | |
| Glass Only | |
|  | GLCL GLFR GLPR |
|  | AC (Acorn Glass -- Clear Stipple Only) |
|  | GLBG (Ball Glass -- White Only) |
| Glass with Cast Guard | |
|  | GLCLGUPC GLFRGUPC GLPRGUPC |
| Glass with Wire Guard | |
|  | GLCLGUP GLFRGUP GLPRGUP |
| Guards Only | |
|  | GLGUPC (Cast Guard) |
|  | GLGUP (Wire Guard) |
| Ballast & Driver Housing | |
|  | RTC |
|  | RTCNC |
|  | DBH |