

Quick Ship

Project: _____
 Fixture Type: _____ Quantity: _____
 Customer: _____

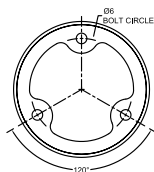
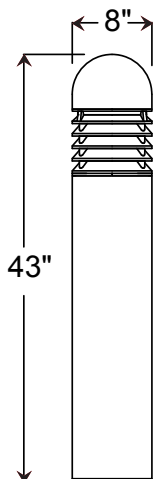

Specifications

Material:
 All parts are durable, high strength aluminum extrusion and spinings. All mounting hardware shall be stainless steel or zinc plated steel.

Lens:
 Frosted acrylic lens

Electrical:
 Medium Base Socket.

Mounting:
 Standard anchor bolts are 3/8" x 12" x 3". Bolts, nuts and washers shall be hot dipped galvanized steel. Bolt pattern diameter is 6".

Finish:
 A polyester powder coat high quality finish is electro-statically applied and baked at 430° for exceptional durability and color retention. Products undergo an intensive five-step cleansing and pretreatment process for maximum paint adhesion.

Marine grade finish provides superior salt, humidity and UV protection. This coating withstands up to 3000 hours of continuous salt spray, comes with a 5-year warranty and is available in either a textured or gloss surface.

Modifications:
 Consult factory for custom or modified designs.

Catalog Logic

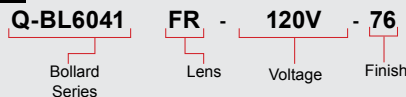

Q-BL6041
70w Max Incandescent

Weight: 24.5 lbs

Catalog Number	
1	2
Q-BL6041	FR - 120V - 76

1	LENS
CL	(Clear Acrylic)
FR	(Frosted Acrylic)

2	VOLTAGES			
120	208	240	277	

3		FINISHES			
Standard Grade	Marine Grade		Standard Grade	Marine Grade	
40	NA	Raw Unfinished	53	100	Copper Clay
41	101	Black	56	109	Silver
42	102	Forest Green	61	106	Black Verde
43	114	Bright Red	70	118	Painted Chrome
44	107	White	71	105	Painted Copper
45	112	Bright Blue	72	108	Textured Black
46	123	Sunny Yellow	73	125	Matte Black
47	120	Aqua Green	76	121	Textured Architectural Bronze
49	NA	Galvanized	77	127	Textured White
50	111	Navy	78	124	Textured Silver
51	103	Architectural Bronze	10	130	Aspen Green
52	104	Patina Verde	11	131	Cantaloupe
12	133	Lilac	13	132	Putty

Consult factory for additional paint charges and availability